

Fall Electives 2017

Classes begin Wednesday, September 6, 2017 unless otherwise noted.

General Electives

- **An Introduction To The Reformation:** In light of the 500th anniversary of the Protestant Reformation, this course will take participants on a guided tour of the key figures and doctrines that derived from this significant movement in church history. Visit the past, meet the characters, and learn about the importance of the Reformation for today. Teacher: Bob Johnson II
- **GriefShare:** This program is designed to help and encourage those who are grieving the loss of a loved one. This weekly seminar and support group is designed to help you rebuild your life. We know it hurts and we want to help. Workbooks are required and will be available in the Bookrack. You can find more information on the Cornerstone website at cbcroseville.org. Facilitator: Dena McGoldrick
- **Biblical Counseling Training Track #1** – This course is designed to introduce students to the theological and methodological foundations of Biblical Counseling. We will discuss what Biblical Counseling is, why we do it, how it differs from other approaches to counseling, and some basic elements of how we do it. Textbook: *A Theology of Biblical Counseling* by Heath Lambert - Teacher: Dave Dunham

Men's Elective

- **The Gospel of Mark:** This video series study will guide participants through the entire Gospel of Mark, wrestling both with the significant issues of the text and life application. Discussion questions and small groups will help to make this an engaging class and growing experience. Leader: Tom Peltier

Women's Electives

- **Precepts: Genesis Part 5 –A Study of Joseph:** Have you ever been falsely accused or suffered from injustice? This study of Joseph is an example of how to handle painful situations. Learn how to rise above difficulties by trusting God. Precepts Textbook - Leader: Terri Lewis
- **Relationships...Biblical Standards:** The Bible can help us to navigate relationships in our lives within our family, friendships and the Body of Christ. Learn how to rightly apply the Word of God in relationships. Teacher: Denise Hardy
- **Genesis 12-30: The lives of Sarah, Rebekah, Rachel and Leah:** Do you want your husband to lead your home spiritually or think you have better plans for your children than God does? Are you tempted to “help God out?” Has God placed you in a strategic position to impact others? These are some of the questions we will deal with in our study. Textbook: *Women of Faith* - Leader: Marilyn Kaynor

Nursery is available for both Tuesday mornings and Wednesday evenings.

Signing up for your class helps us in ordering the correct amount of books and determining room assignments.

Women's Electives - Tuesdays, 9:30 – 11:30 AM

****Beginning September 5, 2017***

- **Genesis 12-30: The lives of Sarah, Rebekah, Rachel and Leah:** Do you want your husband to lead your home spiritually or think you have better plans for your children than God does? Are you tempted to “help God out?” Has God placed you in a strategic position to impact others? These are some of the questions we will deal with in our study. Textbook: *Women of Faith*
Leader: Marilyn Kaynor

****Beginning September 12, 2017***

- **30 Life Principles:** This is a study for growing in knowledge and understanding of God. The principles in God’s word have been given to guide, comfort, instruct, and teach us how to live the Christian life. One hour of homework a week. Leader: Rose Dishman

Nursery is available for both Tuesday mornings and Wednesday evenings.

Signing up for your class helps us in ordering the correct amount of books and determining room assignments.

Fall 2017 WEDNESDAY CLASSES

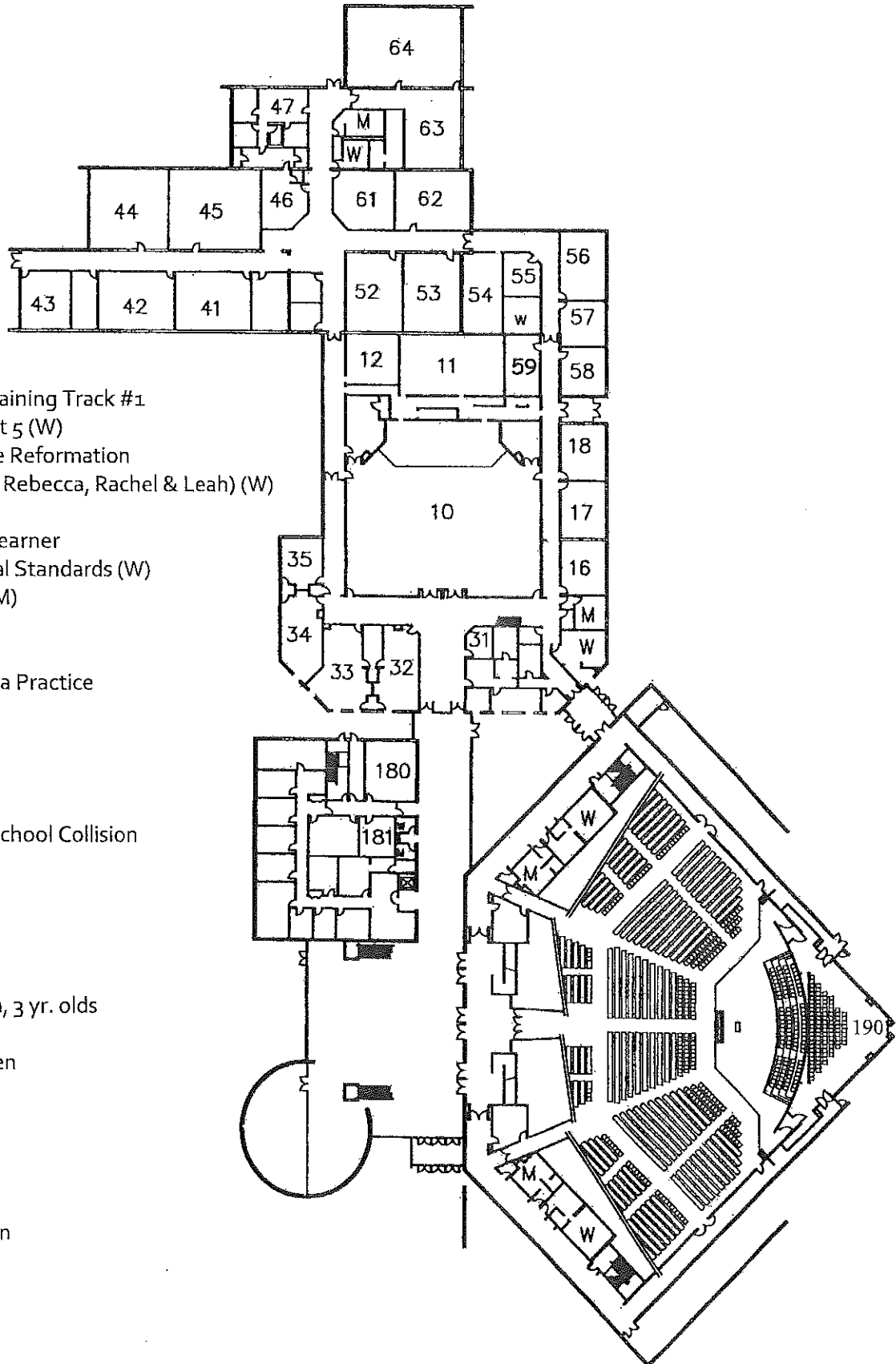

ADULT CLASSES

- 42 Biblical Counseling Training Track #1
- 44 Precepts: Genesis Part 5 (W)
- 45 An Introduction to the Reformation
- 180 Genesis 12-30 (Sarah, Rebecca, Rachel & Leah) (W)
- 190 Choir Practice
- 280-81 English Language Learner
- 282 Relationships...Biblical Standards (W)
- 283 The Gospel of Mark (M)
- 284 ABF Teacher Training
- 287 Griefshare

Worship Center - Orchestra Practice

(W) = women only

(M) = men only

STUDENTS

- 11 Middle School/High School Collision

TRUTHOPOLIS

- 32 Infant Nursery
- 33 Walkers
- 35 2-yr. olds
- 52 3 & 4 yr. olds Check In, 3 yr. olds
- 62 4-yr. olds
- 53 5-yr. olds/Kindergarten
- 55 1st Grade
- 56 2nd Grade
- 54 3rd Grade
- 61 4th Grade
- 17 5th Grade
- 64 K - 5th Grade Check-in

IGNITE

- 57-58 6th Grade

Lower Level Floor Plan

Cornerstone Baptist Church

Fall 2017
WEDNESDAY CLASSES

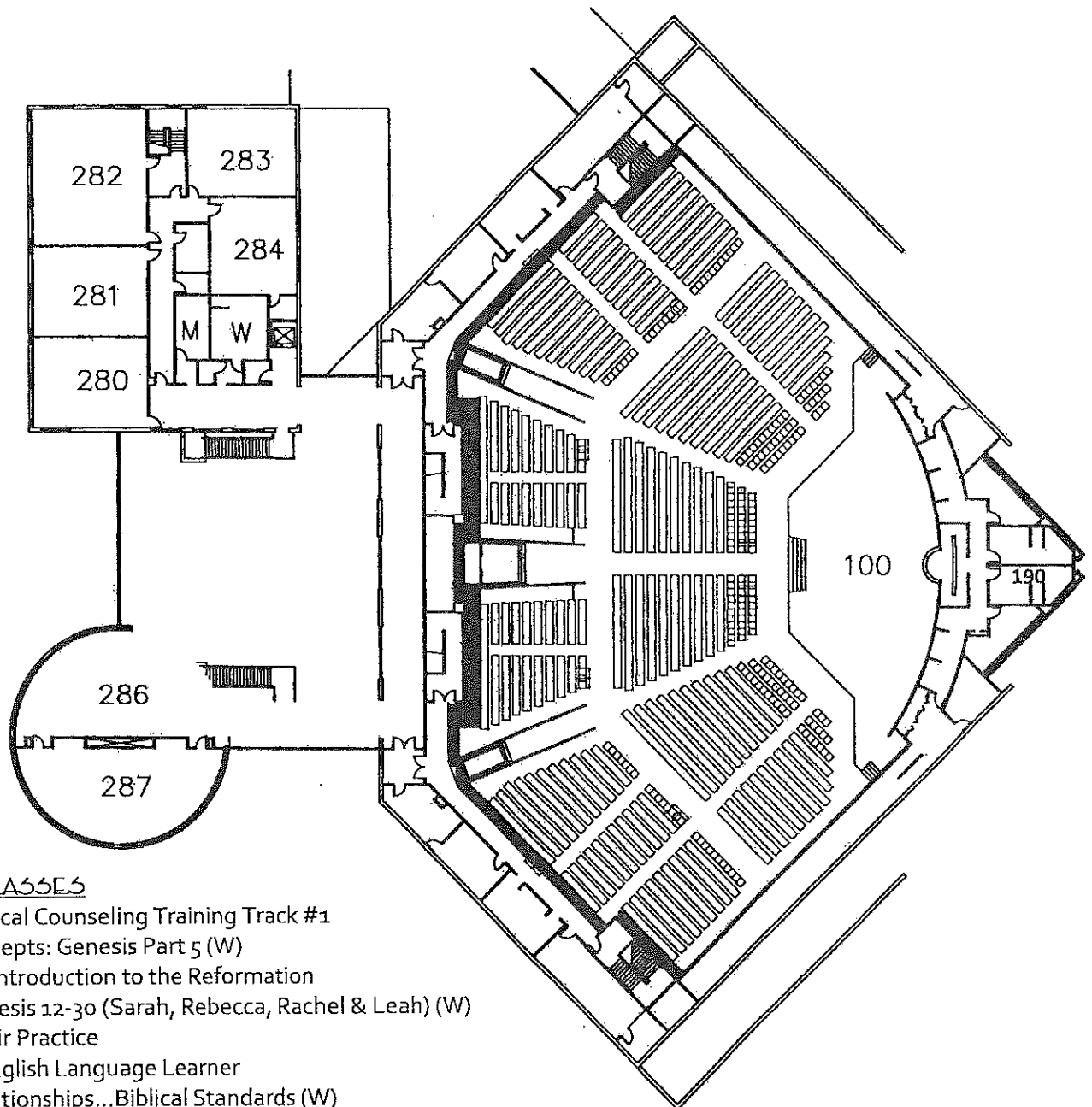

ADULT CLASSES

- 42 Biblical Counseling Training Track #1
- 44 Precepts: Genesis Part 5 (W)
- 45 An Introduction to the Reformation
- 180 Genesis 12-30 (Sarah, Rebecca, Rachel & Leah) (W)
- 190 Choir Practice
- 280-81 English Language Learner
- 282 Relationships...Biblical Standards (W)
- 283 The Gospel of Mark (M)
- 284 ABF Teacher Training
- 287 Griefshare

Worship Center - Orchestra Practice

(W) = women only

(M) = men only

Upper Level Floor Plan

Cornerstone Baptist Church